



EMG GERMANY



KALSCHEURENER STR. 89
50354 HUERTH
02233 – 969 0

STUDIO 1 - 1.045 sqm



Basic dimensions:	51,40 m x 20,30 m
Studio area:	1.045 sqm
Height of the light grid:	7,55 m
Height of the curtain rail:	6,75 m
Height of the steel beams:	6,65 m
Length of the curtain rail:	76,50 m (Studio 1a), 78,00 m (Studio 1b)
Width of the perimeter:	1,00 m
Dimensions of the gates:	Gate 1: 3,85 m x 3,90 m (H/W) Gate 2: 3,96 m x 3,00 m (H/W)

Thanks to our technical production network, Studio 1 can be operated with our HD fixed control rooms 1 & 6 or the OB van. In addition, all control rooms are directly connected to post-production. Studio 1 can be divided by curtains (2 x 522 sqm). More than 13 ancillary and guest rooms are available within the building, as well as two mask rooms and additional mobile masks if required.

The foyer covers 300 sqm. Sanitary facilities and checkrooms are available.

STUDIO 1 - 1.045 sqm

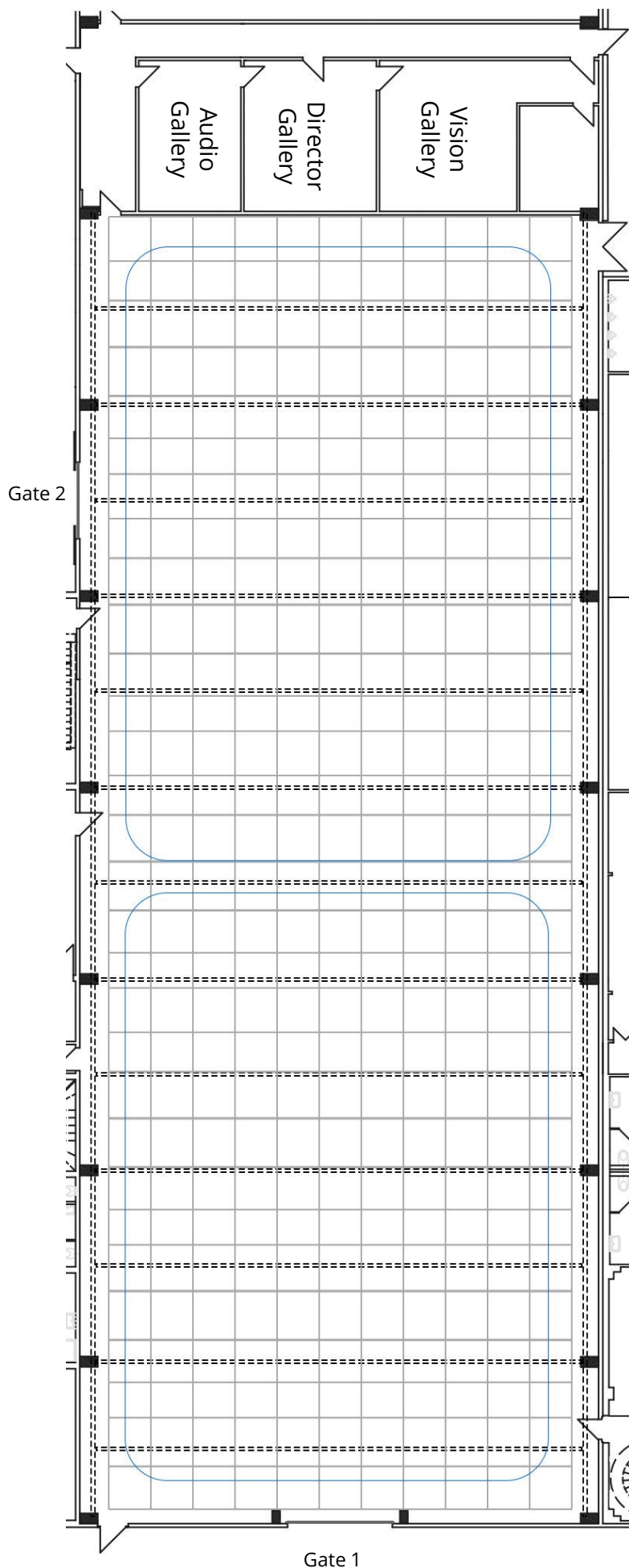

LEGEND

=== Steel grider

⊕ Light grid

— Curtain rail

Basic dimensions:

51,40 m x 20,30 m

Studio area :

1.045 sqm

Height of the light grid:

7,55 m

Height of the curtain rail:

6,75 m

Height of the steel beams:

6,65 m

Length of the curtain rail:

76,50 m (Studio 1a)

78,00 m (Studio 1b)

Width of the perimeter:

1,00 m

Dimensions of the gates:

Gate 1: 3,85 m x 3,90 m (H/W)

Gate 2: 3,96 m x 3,00 m (H/W)

STUDIO 1 - 1.045 sqm

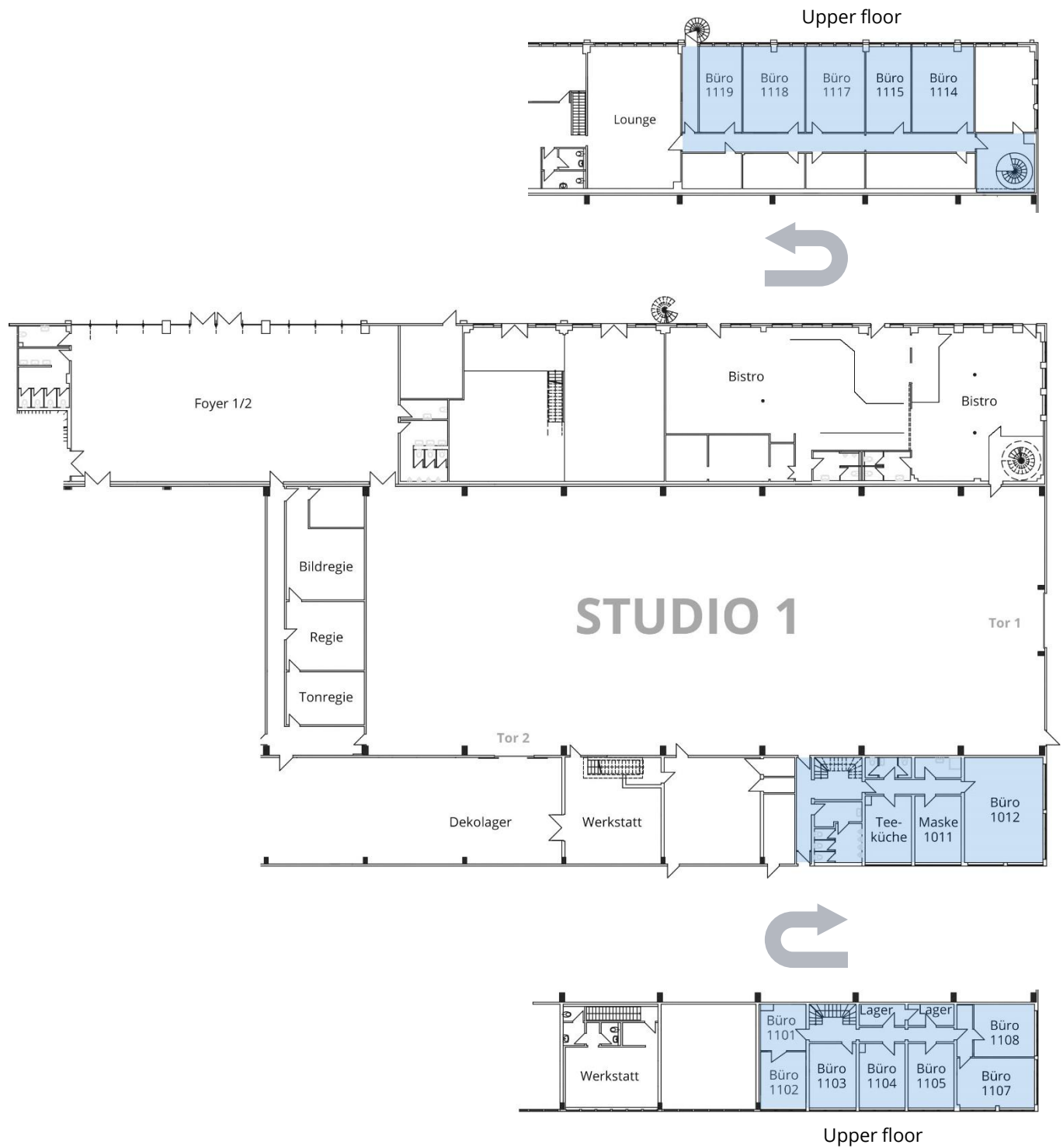

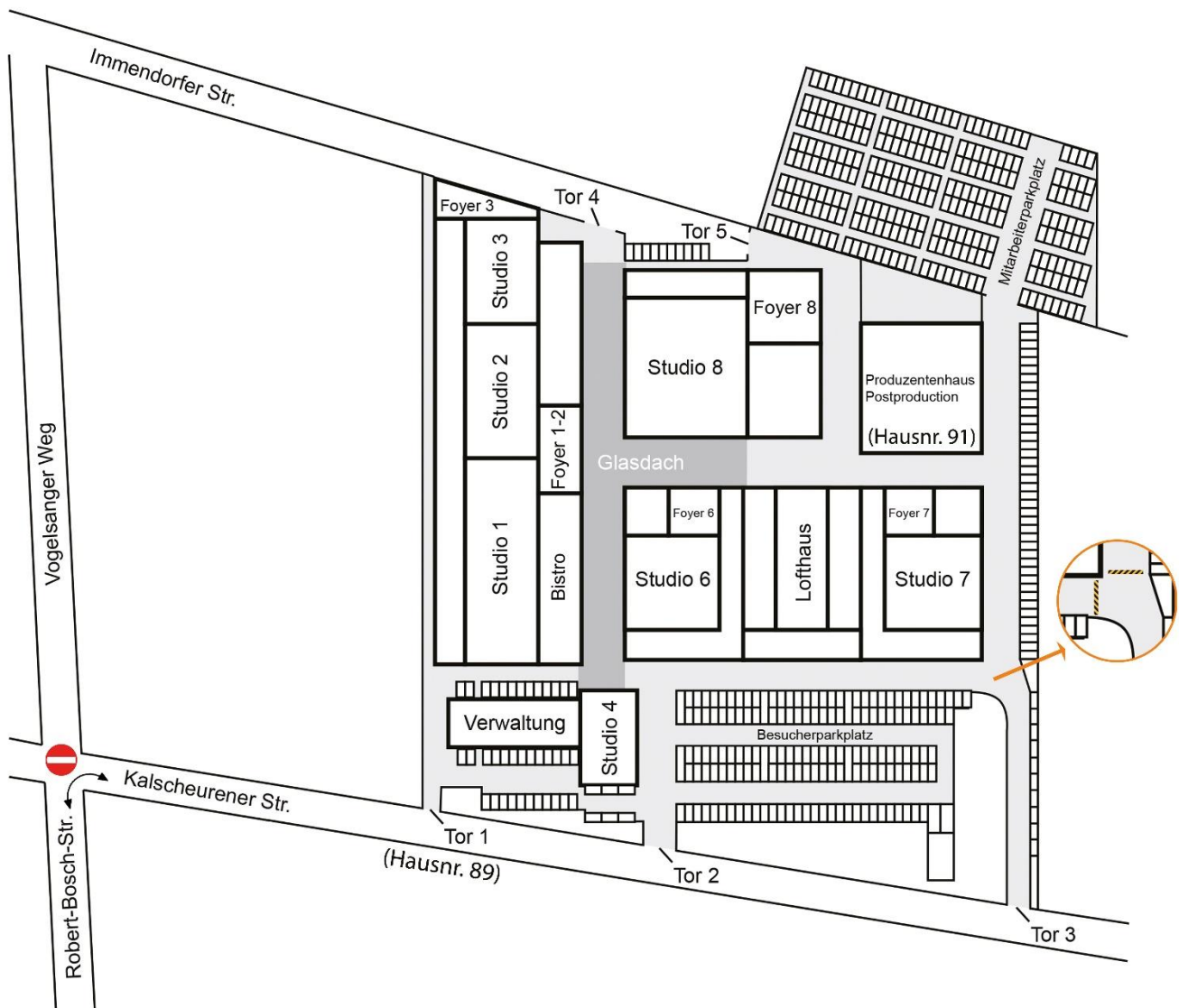

ARRIVAL: CAR | TRAIN | COACH | DELIVERY

Leave the highway at the Köln-Klettenberg (Hürth/Zentrum) exit. Then turn left at the end of the highway exit onto Luxemburger Straße in the direction of Schleiden, Brühl, Hürth-Knapsack.

Follow Luxemburger Straße to the intersection of the Hürth bypass at the "Café del Sol" restaurant (right-hand side). At the crossroads, turn left into the Gewerbegebiet Nord-Ost (Jägerpfad). At the traffic circle, take the second exit (Robert-Bosch-Straße). Take the right-hand bend at the end of the road onto Kalscheurener Straße. The studios are approx. 100 m down the road on the left-hand side.

TRAIN

From Cologne Central Station, take the streetcar (KVB) line 18 in the direction of Bonn/Brühl. Please get off at the Efferen stop. The journey takes 20 minutes.

From the bus stop, turn left onto Kaulardstraße in the direction of Luxemburger Straße. Cross the pedestrian crossing, turn right and walk along Luxemburger Straße for about 50 m before turning left into Kalscheurener Straße. You will find the studios after about 800 m on the left-hand side (next to Premio Reifen + Autoservice).

COACH

Please drive through gate 3 onto the driveway to the employee parking lot. Please register at the employee barrier (long-term parking) and continue straight on to the large employee parking lot.

DELIVERY

Please drive through gate 3 to the driveway to the parking lots. Please take a parking ticket at the respective barrier. If you need longer, you can ask the recipient of your goods for an exit ticket or pay for your ticket at the machine in front of Foyer 1+2 or between Studio 8 and the Producer's House (Produzentenhaus).



KALSCHEURENER STRASSE 89
50354 HUERTH
GERMANY

EMGLIVE.COM